



## PRODUCT INSTRUCTION

Shenzhen Shi Yutong Technology Co., LTD



Note : only suitable for charging voltage below 5v. Do not charge the device with voltage over 5v.

## IMPORTANT SAFETY INFORMATION

- A) PLEASE DO NOT LOOK DIRECTLY INTO THE INFRARED LIGHT BEAM FROM THE IR TORCH AS THIS MAY RESULT IN PERMANENT EYE DAMAGE.
- B) DUE TO THE POWER OF THE INFRARED LIGHT, DO NOT PROJECT THE BEAM ONTO ANY FLAMMABLE OBJECT AS THIS MAY RESULT IN A FIRE. WHEN NOT IN USE SWITCH OFF THE DEVICE OR PLACE IT INTO SLEEP MODE.
- C) ATTEMPTS TO DISASSEMBLE OR REPAIR THE DEVICE WITHOUT AUTHORISATION WILL VOID THE MANUFACTURERS WARRANTY AND MAY RESULT IN DAMAGE TO YOUR DEVICE.
- D) DISASSEMBLY OF YOUR DEVICE FOR MAINTENANCE PURPOSES IS STRICTLY PROHIBITED AND COULD CAUSE YOUR DEVICE TO PERFORM UNPREDICTABLY.
- E) CAUTION – USE OF CONTROLS, ADJUSTMENTS OR PERFORMANCE OF PROCEDURES OTHERS THAN THOSE SPECIFIED HERE MAY RESULT IN HAZARDOUS RADIATION EXPOSURE.

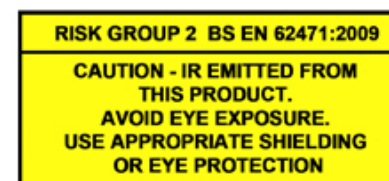

**CAUTION - IR EMITTED FROM THIS PRODUCT. AVOID EYE EXPOSURE. USE APPROPRIATE SHIELDING OR EYE PROTECTION. BS EN 62471:2009**

**THE LAMP OR LAMP SYSTEM IN THIS PRODUCT IS IN EXCESS OF THE EXEMPT GROUP AND THE VIEWER RELATED RISK IS DEPENDENT UPON HOW THE USER INSTALLS AND USES THIS PRODUCT.**

**THE NOHD (NOMINAL OPTICAL HAZARD DISTANCE) IS 1.6M FOR THIS DEVICE. THE EHV (EXPOSURE HAZARD VALUES) IS 40% OF THE LIMIT OF THE PERCENTAGE OF THE ACCESSIBLE EMISSIONS.**



-3-

## Components

- |                          |                     |
|--------------------------|---------------------|
| 1*HT60 Standard Version; | 1* Micro USB cable; |
| 2*Hex-nut wrenches;      | 1* Mount            |

Storage card is not included. Please prepare a TF card (128g maximum) for data storage.

## Installation

### 1. Battery

Please use lithium chargeable 3.7V flat battery 18650. Remove battery compartment cap and make sure setting the positive polar towards to the direction inward. Put the cap back and screw it until tight. ( Fail to do so may result in restarting!).

-5-

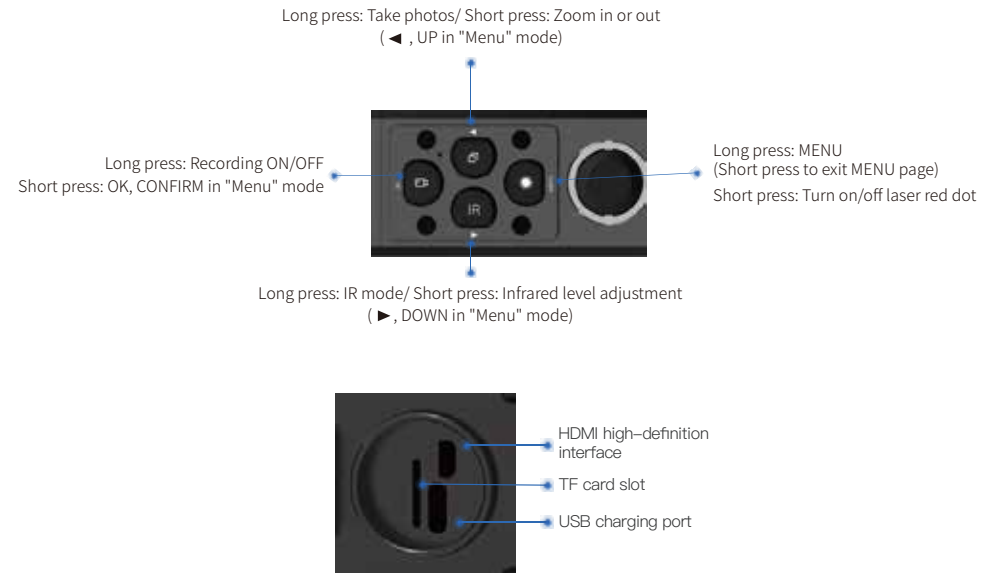

-4-

### 2. Adjustments

To check the function after the installation of battery. First, rotate and adjust the eyepiece dioptre adjustment ring(3) until you see the four-character icon on the screen ( there's no need to see a clear image ), then rotate the Objective lens adjustment ring(4) until you can see your target clearly. Second, switch to different modes, test IR, Red dot or Rangefinder.

### 3. Mount Installation

There are three mounting holes in the base of the device. Attach the mount to the base of the device by using a hex-nut wrench and screws. The mount can be installed in multiple rails.

-6-

# Instructions

## 1. Turn On/Off

Turn on the device with a short press of Power button(1/2). Turn off the device with a long press of Power button(1/2). Power indicator will keep ON when the device is turned on.

## 2. Sleep Mode

Enter sleep mode with a short press of Power/Sleep button(1/2) when the device is turned on. Power indicator will keep ON when the device entering sleep mode.

## 3. The Eyepiece Dioptre Adjustment

The purpose of dioptre adjustment is to get a clear image for users with different vision. Rotate and adjust the dioptre adjustment ring (3) until

-7-

## 6. Red dot Adjustment

Turn on the device, then turn the laser on/off with a short press of Laser/Menu button. The position of laser can be adjusted on the laser adjustment holes(6) by a hex-nut wrench.

## 7. Menu operation

Enter the menu with a long press of Menu button. Press ◀/▶ button to select options. Enter a submenu with a short press of OK button. Exit the menu with a short press of Menu button.



-9-

you get a clear view of the four-character icon on the screen. One adjustment only for each eye-view.

(Please note it's possible that the image is not clear without the adjustment of objective lens.)

## 4. The Objective Lens Adjustment

Make sure the eyepiece dioptre adjustment is finished. Aiming at your target, rotate and adjust the objective lens ring until you get a clear and well-focused image.

## 5. IR Fill Light Control

Turn on the device, enter black and white mode with a long press of IR button. Switch to IR1-3 or off with a short press of IR button. The part of fill light(5) is stretchable which can be pull out or push back to make a quick adjustment.

-8-

## 1 >PIP (Picture-in-Picture)

Enter the submenu PIP mode with a short press of OK button. Select “off, on, shortcut key off or shortcut key on” with ◀/▶ button. Confirm your selection with a short press of OK button.

Once the shortcut key of PIP is turned on, enter or exit PIP mode with a short press of Menu button(7). (Laser function can not work in this situation)

## 2 >Reticle Adjustment

Enter the submenu reticle adjustment with a short press of OK button . Select options with a short press of OK button. Adjust options or value with some short press of ◀/▶ button .

To confirm your setting by enter “Save” with a short press of + button , choose “Yes” with a short press of OK button; To deny your setting by enter “Save” with a short press of - button, choose “No” with a short press of OK button.

-10-

### 3>Gyroscope

Enter the submenu Gyroscope with a short press of OK button. Select "Display" or "Calibration" with a short press of ◀/▶ button. Select "On" or "Off" to turn on/off the gyroscope after entering "Display". Turn on the gyroscope before you select "Calibration". Enter "Calibration" by pressing OK button. Keep the machine level and remain still for about 8 seconds to complete the calibration.

### 4>Default Magnification

Enter the submenu Default Magnification with a short press of OK button. Select "6.5x" or "13x" as default magnification. Confirm your selection with a short press of OK button.

### 5>Default Color

Enter the submenu Default Color with a short press of OK button. Select

-11-

### 8>Range Unit Selection

Enter the submenu range unit selection with a short press of OK button. Select "Meter" or "Yard" with a short press of ◀/▶ button. Confirm your selection with a short press of OK button.



### 9 >Auto Recording

Enter the submenu Auto Recording with a short press of OK button. Select "Off" or "On" with a short press of ◀/▶ button. Confirm your selection with a short

-13-

"Colorful" or "Black / White" mode with a short press of ◀/▶ button. Confirm your selection with a short press of OK button.

### 6>Brightness Of IR

Enter the submenu Brightness of IR with a short press of OK button. Select "Off", "1", "2", or "3" with a short press of ◀/▶ button. Confirm your selection with a short press of OK button. Please note this setting is for the default brightness of IR. Pressing IR button under Black & White mode for instant setting of IR brightness.

### 7>LCD Brightness

Enter the submenu Brightness with a short press of OK button. Select "Super Dark", "Dark", "Normal", "Bright" "Super Bright" with a short press of ◀/▶ button. Confirm your selection with a short press of OK button.

-12-

press of OK button.

### 10>Loop Recording

Enter the submenu Loop Recording with a short press of OK button. Select "Off", "3 minutes", "5 minutes" or "10 minutes" with a short press of ◀/▶ button. Confirm your selection with a short press of OK button.

### 11 >Date Stamp

Enter the submenu Date Stamp with a short press of OK button. Select "Off" or "On" with a short press of ◀/▶ button. Confirm your selection with a short press of OK button.

### 12>Record Audio

Enter the submenu record audio with a short press of OK button. Select "Off" or "On" with a short press of ◀/▶ button. Confirm your selection with a short press of OK button. This setting is to realize an audio or a silent video.

-14-

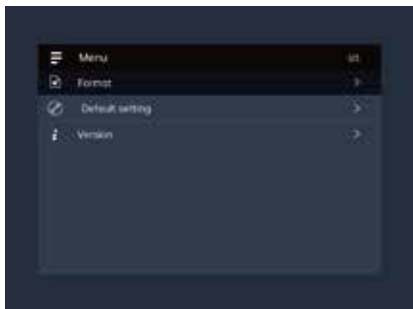

### 13 >Playback

Enter the submenu Playback with a short press of OK button. Select “Record” or “Photo” with a short press of ◀/▶ button. Confirm your selection with a short press of OK button to browse videos or photos.

### 17 >Date/ Time

Enter the submenu “Date/Time” with a short press of OK button②. Select one of the options with OK button②. Select a correct value for year, month and date with a short press of ◀/▶ button. Select “YY /MM/DD”, “MM/DD/YY” or “DD/M–M/YY” as your date format with a short press of ◀/▶ button. Save selected date and exit the submenu with a short press of Menu button(7).

### 18 >Format

Enter the submenu “Format” with a short press of OK button ②. Select “Memory” or “ TF card” with a short press of ◀/▶ button. Confirm your selection with a short press of OK button②.

Please be careful, the data can not be recovered after the device is formatted.

### 19 >Default Setting

Enter the submenu “Default Setting” with a short press of OK button ②. Select “Cancel” or “ OK” with a short press of ◀/▶ button. Confirm your selection with a short press of OK button②.

### 14 >WiFi

Enter the submenu WiFi with a short press of OK button②.

Select “Off” or “On” with a short press of ◀/▶ button. Confirm your selection with a short press of OK button②. Exit WiFi with a long press of Menu button (7). (The Menu page can not be opened while WiFi is turned on) The corresponding APP is available in its official website.

### 15 >Exposure

Enter the submenu exposure with a short press of OK button②. Select one of the options with a short press of ◀/▶ button. Confirm your selection with a short press of OK button②.

### 16 >Language

Enter the submenu Language with a short press of OK button②. Select one of the options with a short press of ◀/▶ button. Confirm your selection with a short press of OK button②.

## 8. Shortcuts

### 🔌 Power/Sleep button

Turn on the device with a short press of power button, turn off the device with a long press of power button. Enter or exit sleep mode with a short press of sleep button.

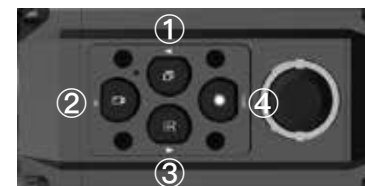

#### ①.Zoom(+) / Photo Taking

Zoom in or out with a short press of zoom button. Taking photos with a long press.

### ②.OK / Recording

Turn on/ off recording with a long press. Confirm your selection by pressing OK button.

### ③.IR/ mode switch (-) button

Switch between Black and White/Colorful mode with a long press of IR button. Pressing IR button under Black & White mode for instant setting of IR brightness.

### ④.Red dot button/ Menu

Turn on or off the red dot with a short press of red dot button. Enter the menu page with a long press of red dot button , exit the menu page with a short press.

## Warranty card

Product model:.....

Product code:.....

Date of purchase:.....

Warranty period:.....

User Name:.....

User's phone:.....

User address:.....

Warranty records:.....

## Specifications

Model	HT60	Battery	18650X1	Dimension	148mmX71mm X50mm
Magnifying power	6.5X-13X	Focusing	2m-∞	Eyepiece resolution	1024X768
Voltage	3.7V	IR wavelength	850nm	IR power	5W
IR illuminate distance	200m	Output type	AVI	Data transmission	WIFI
Frame rate	30fps	Battery life	> 8h	Video resolution	1920X1080
Storage type	TF card	Net weight	420g		

## Warranty

This product is warranted against defects in materials and workmanship for a period of one year from the date of purchase.

This warranty is for the original purchaser only!

Notice:

Do not disassemble the night vision device by yourself. If there is any trouble, please contact the factory in time. If the repair, modification or product seal sticker is not approved by the company, it will not be covered by the warranty.

All damage caused by human factors or accidental product damage, including use in abnormal working conditions, damage caused by failure to follow the instructions and installation, is not covered by the warranty.

## Key Specifications

### General Specifications

- (1) 1x1 2.4GHz frequency band (channels 1–11)
- (2) PHY supporting IEEE 802.11b/g/n
- (3) MAC supporting IEEE 802.11 d/e/h/i/k/v/w
- (4) Built-in PA and LNA, integrated with TX/RX Switch and Balun
- (5) Station (STA) and access point (AP) modes, up to six STA devices allowed for access as an AP
- (6) WPA WPA, WPA WPA2 personal, and WPS2.0
- (7) 2/3/4-line PTA solution with BT and BLE chips coexisting
- (8) Input voltage range: 2.3–3.6 V; I/O power voltage: 1.8 V or 3.3 V
- (9) RF auto-calibration solution

–23–

## FCC Warning

Any Changes or modifications not expressly approved by the party responsible for compliance could void the user's authority to operate the equipment.

This device complies with part 15 of the FCC Rules. Operation is subject to the following two conditions:

- (1) This device may not cause harmful interference, and
- (2) this device must accept any interference received, including interference that may cause undesired operation.

–25–

### PHY Features

- (1) All single-antenna data rates of IEEE802.11b/g/n
- (2) Maximum rate of 72.2Mbit/s@HT20 MCS7
- (3) Standard 20MHz bandwidth
- (5) STBC RX
- (6) Short GI

### MAC Features

- (1) A-MPDU and A-MSDU
- (2) Blk-ACK
- (3) QoS

### Other Information

- (1) Operating temperature: –40°C to +85°C (–40°F to 185°F)

–24–

Note: This equipment has been tested and found to comply with the limits for a Class B digital device, pursuant to part 15 of the FCC Rules. These limits are designed to provide reasonable protection against harmful interference in a residential installation. This equipment generates uses and can radiate radio frequency energy and, if not installed and used in accordance with the instructions, may cause harmful interference to radio communications. However, there is no guarantee that interference will not occur in a particular installation. If this equipment does cause harmful interference to radio or television reception, which can be determined by turning the equipment off and on, the user is encouraged to try to correct the interference by one or more of the following measures:

–26–



- Reorient or relocate the receiving antenna.
  - Increase the separation between the equipment and receiver.
  - Connect the equipment into an outlet on a circuit different from that to which the receiver is connected.
  - Consult the dealer or an experienced radio/TV technician for help.
- This equipment complies with FCC radiation exposure limits set forth for an uncontrolled environment



-27-

